

THE CORPORATION OF
TOWNSHIP OF WHITEWATER REGION

BY-LAW # 07-01-274

A By-law to amend By-law Number 02-11-86 of the Corporation of the Township of Whitewater Region, as amended.

**PURSUANT TO SECTION 34 OF THE PLANNING ACT, THE TOWNSHIP OF
WHITEWATER REGION HEREBY ENACTS AS FOLLOWS:**

1. THAT By-law Number 02-11-86, as amended, be and the same is hereby further amended as follows:
 - (a) Schedule "A" attached hereto is hereby added to By-law Number 02-11-86 as Schedule "D".
2. By amending SECTION 5 – REQUIREMENTS FOR RESIDENTIAL ONE (R1) ZONES, by adding immediately after 5.3(b), the following:
 - (c) Residential One-Exception Three (R1-E3)

Notwithstanding Section 5.2(a) and (e) to the contrary, for those lands described as part of Lot 7, Concession 5, E.M.L., in the geographic Village of Beachburg and delineated as Residential One-Exception Three (R1-E3) on Schedule "D" to this By-law, the following shall apply:

 - (i) Lot Area (minimum) 1800 square metres
 - (ii) Rear Yard Depth (minimum) 7.5 metres"
3. THAT save as aforesaid all other provisions of By-law Number 02-11-86, as amended, shall be complied with.
4. This by-law shall come into force and take effect on the day of final passing thereof.

This By-law given its FIRST and SECOND reading this 17th day of January, 2007.

This By-law read a THIRD time and finally passed 17th day of January, 2007.

MAYOR

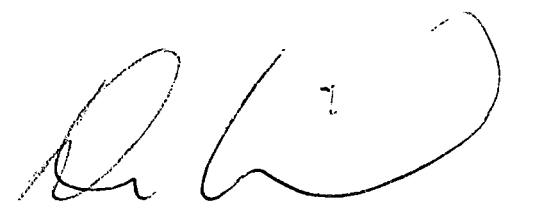
CAO/CLERK

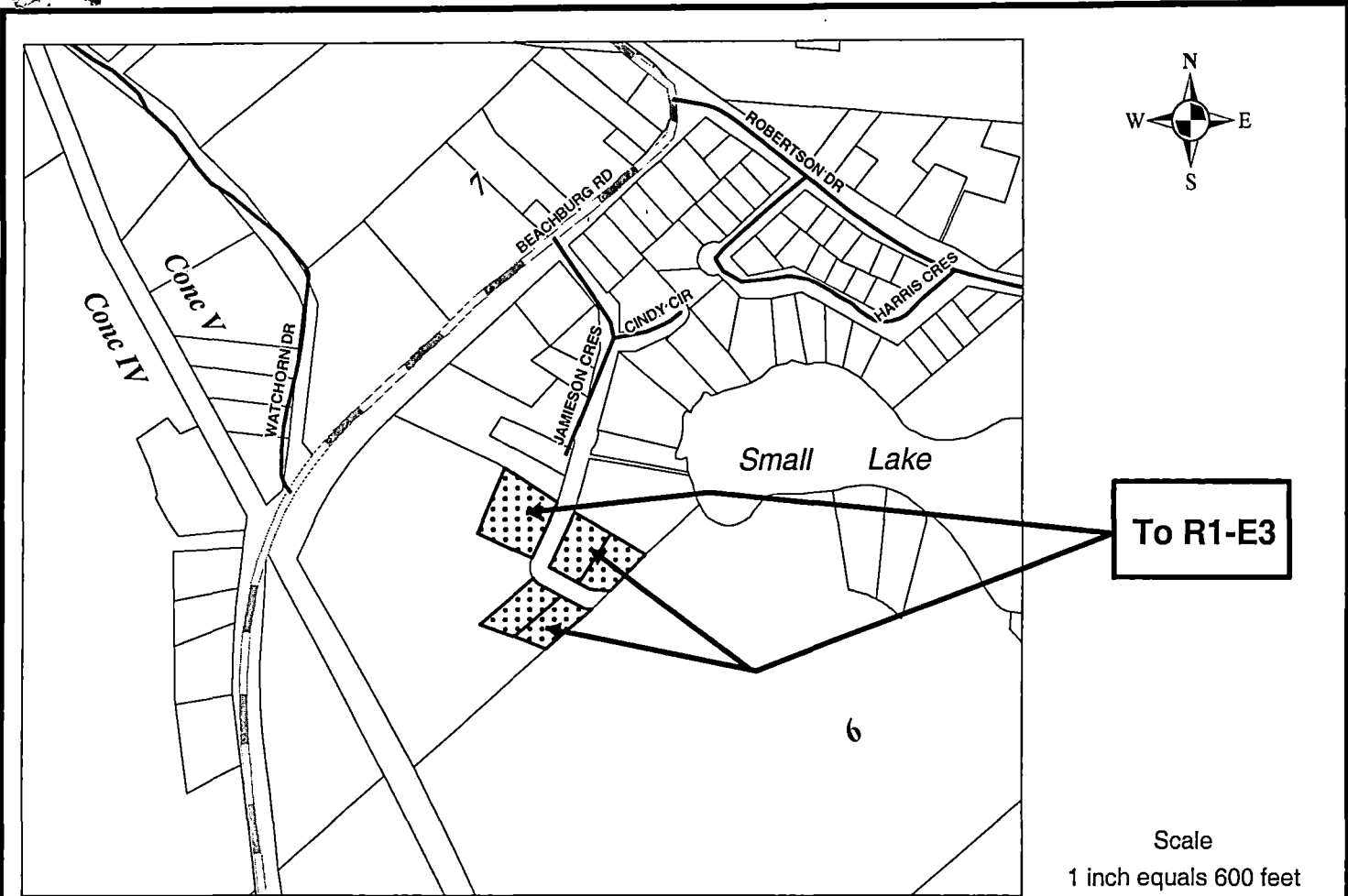

**CORPORATION OF THE
TOWNSHIP OF WHITEWATER REGION**

This is Schedule "A" to By-law Number 07-01-274.
Passed the 17 day of January 2007.

Signatures of Signing Officers:

Orville Rothwell
Reeve Mayor

[Signature]
CAO/Clerk

LEGEND



Residential One



Area affected by this Amendment
To R1-E3



Exception Zone

This is Schedule "D" to By-law 02-11-86.